

How do I add a student to my class?

1. Log in to your [Educator Center](#) (educate.aofl.com) account.

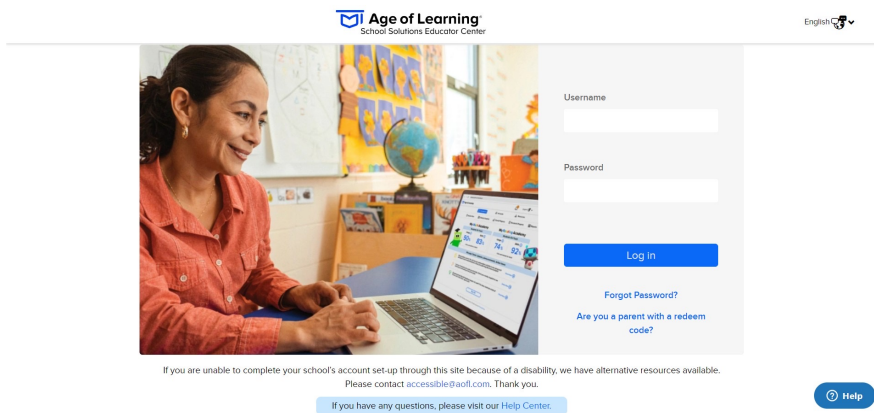

2. Click on the **Accounts** label located at the top of your screen.

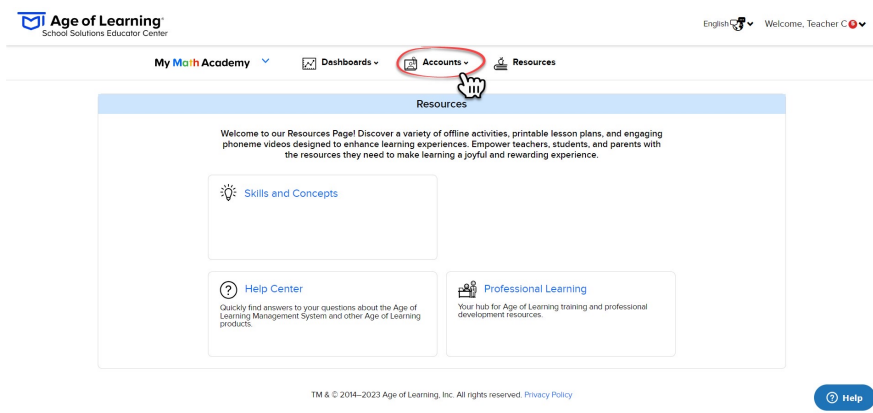

3. Use the drop-down menu to select the **Manage** tab.

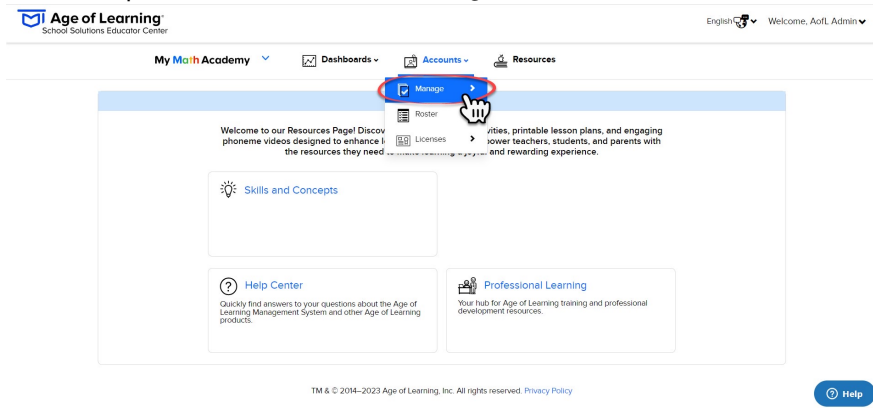

4. Select the **Students** tab.

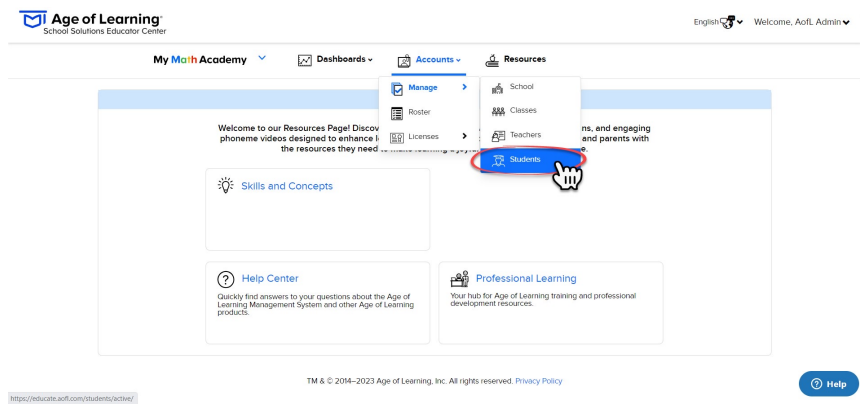

5. Select the **+Create Student** hyperlink.

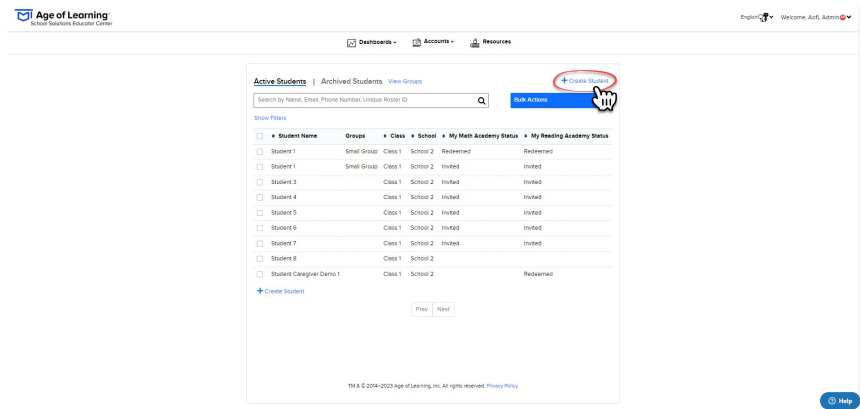

6. Fill out the information required in the provided field boxes on the **Student Info** pop-up.

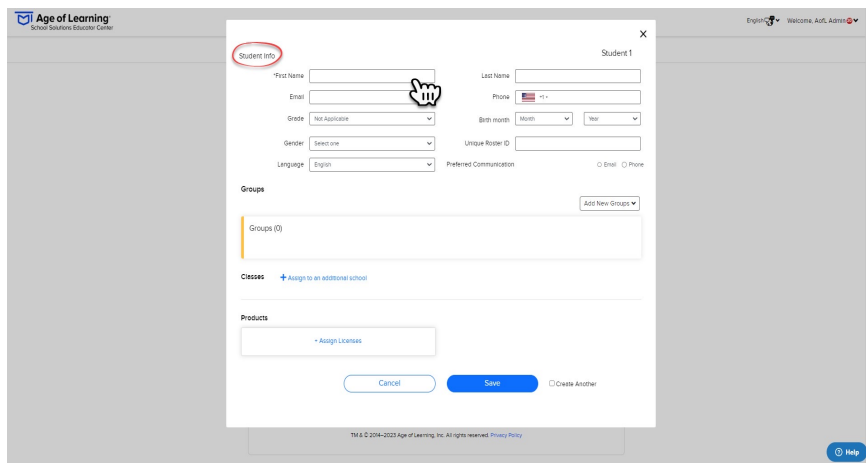

7. Click **Save**.

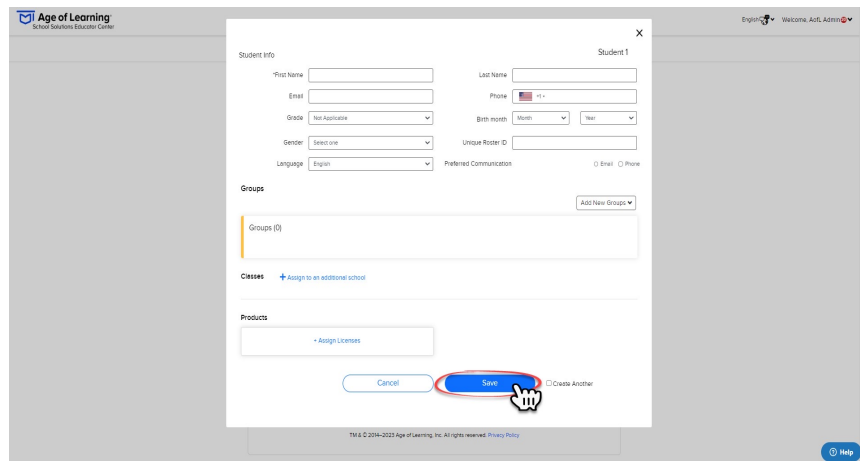

Understanding How to Fill Out Student Information

Remember, the only mandatory field is the student's name. However, for an enhanced student experience with the Age of Learning product, we highly recommend including the following information:

- **Email:** Used to send invitations to parents/caregivers for at-home access.
- **Language:** For some Age of Learning products, this will determine the language used in the game. This will also determine the language of the invitations sent to parents/caregivers for at-home access.
- **Birth month and year:** Determines whether the student is presented with the appropriate placement activities for the adaptive learning products, like *My Math Academy* and *My Reading Academy*.

Contact Us



Chat with Us



TM & © 2007-2023 [Age of Learning, Inc.](#) All rights reserved.

[Privacy Policy](#) | [Customer Support](#) | [Accessibility Statement](#)

End of ADA chat widget